

# Martin® Railcar Vibrator Storage Stand & Cart Assembly Instructions



This document provides product names, corresponding part numbers, and assembly procedure for the [Martin® Railcar Vibrator Storage Stand & Cart](#). Please reference part numbers when ordering parts:

- **Martin® Railcar Vibrator Storage Stand & Cart**, P/N RV10016P
- **Optional: Martin® Airline Control Kit**, P/N 39504

## IMPORTANT

**The delivery service is responsible for damage occurring in transit. Martin Engineering CANNOT enter claims from damages. Contact your transportation agent for more information.**

1. Inspect shipping container for damage. Report damage to delivery service immediately and fill out delivery service's claim form. Keep any damaged goods subject to examination.
2. Remove storage stand & cart contents from shipping container. Compare content to drawing supplied with container. Contents may vary dependent upon assembly option ordered. Contents in containers should include the following as the default option:
  - Martin® Railcar Vibrator Storage Stand & Cart Upper Assembly
  - Martin® Railcar Vibrator Storage Stand & Cart Lower Assembly
  - Martin® Railcar Vibrator Storage Stand & Cart Tool Tray
  - Martin® Railcar Vibrator Storage Stand & Cart Wedge Weldment
3. If anything is missing or damaged, contact Martin Engineering or a representative.

### *Assembling Storage Cart*

1. Align upper assembly to lower wheeled assembly, ensuring the holes are properly aligned at the currently desired height. Using supplied hardware, fix the upper assembly into place within lower assembly at the currently desired height. (Refer to Figure 1.)
2. Install the tool tray onto the desired side of the assembly using supplied hardware. (Refer to Figure 1.)
3. Attach wedge weldment onto upper assembly using supplied hardware. Secure wedge weldment into place at desired angle. Possible angle configurations are 0° to 35°. (Refer to Figure 2 & 3.)

### *Attaching Optional Airline Control Kit*

1. Install the regulator mounting plate onto the cart assembly using the hardware provided, in the configuration shown in figure 4. (Refer to Figure 4 & 5.)
2. Install the regulator supplied in airline kit onto the mounting plate on the cart using the hardware provide. (Refer to Figure 4 & 5.)

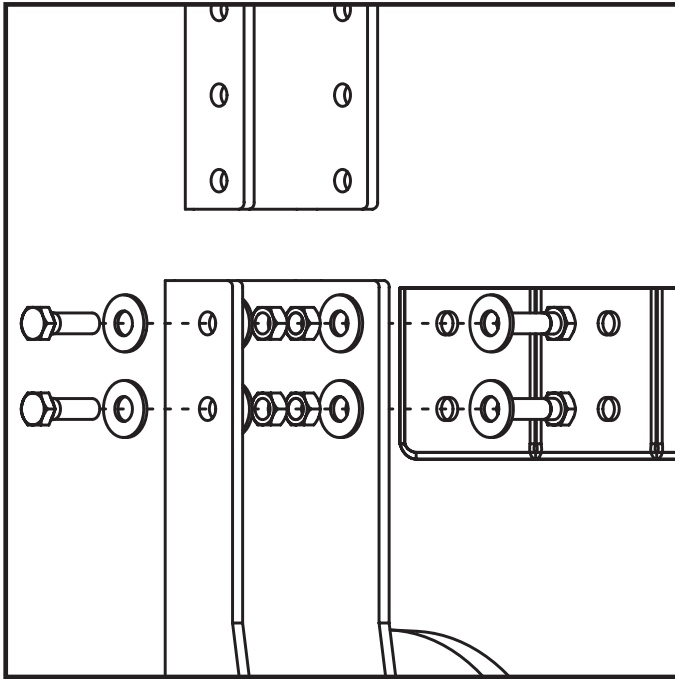

Figure 1. Railcar Vibrator Storage Stand & Cart Connection of Lower to Upper Assembly

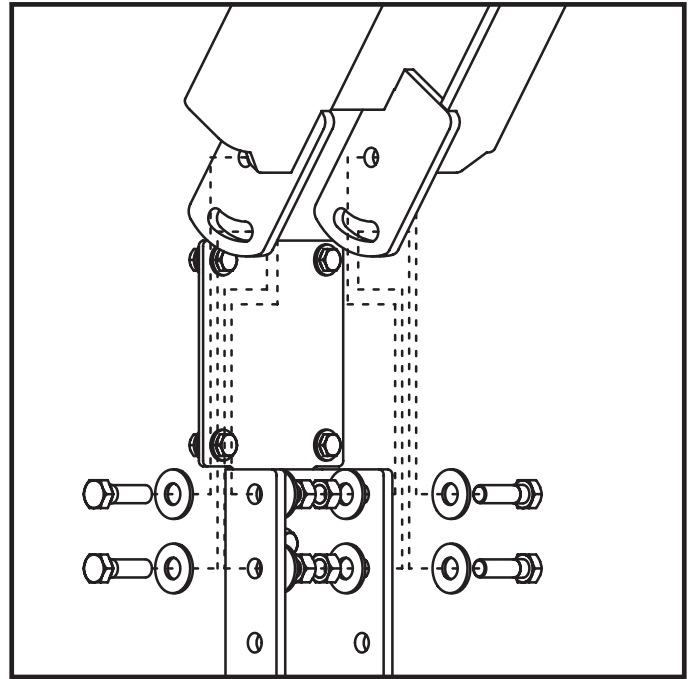

Figure 2. Railcar Vibrator Storage Stand & Cart Connection of Assembly to Wedge Weldment

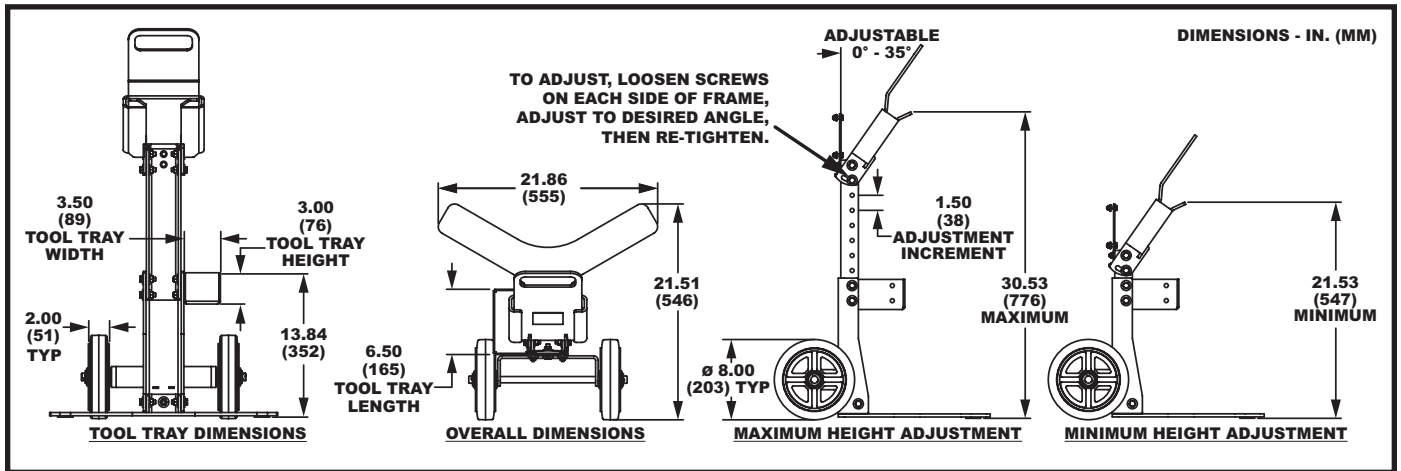

Figure 3. Railcar Vibrator Storage Stand & Cart Dimensions

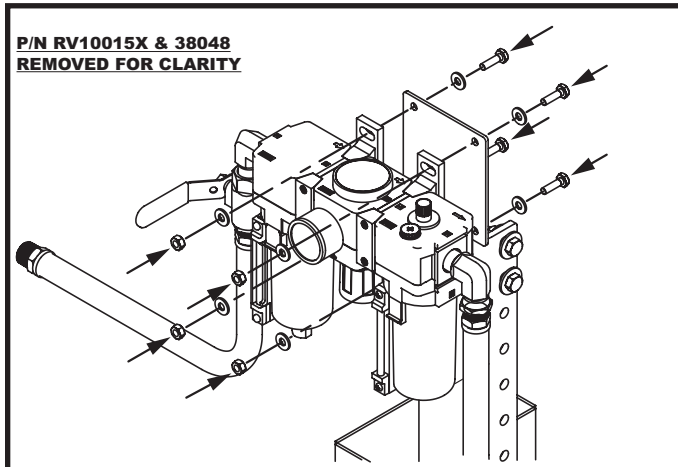

Figure 4. Connecting Optional Airline Control Kit, P/N 39504

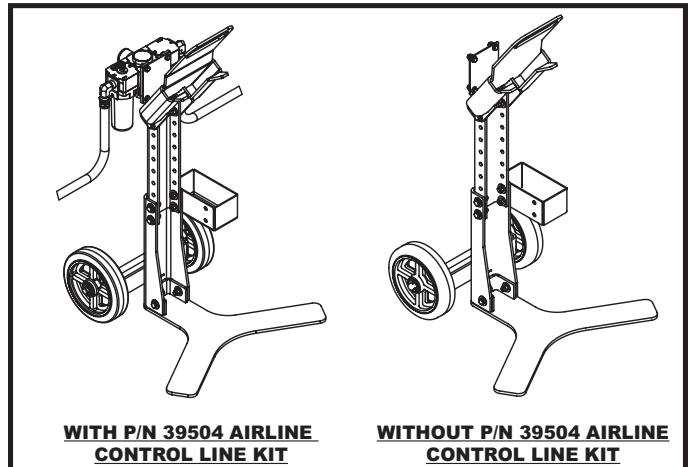
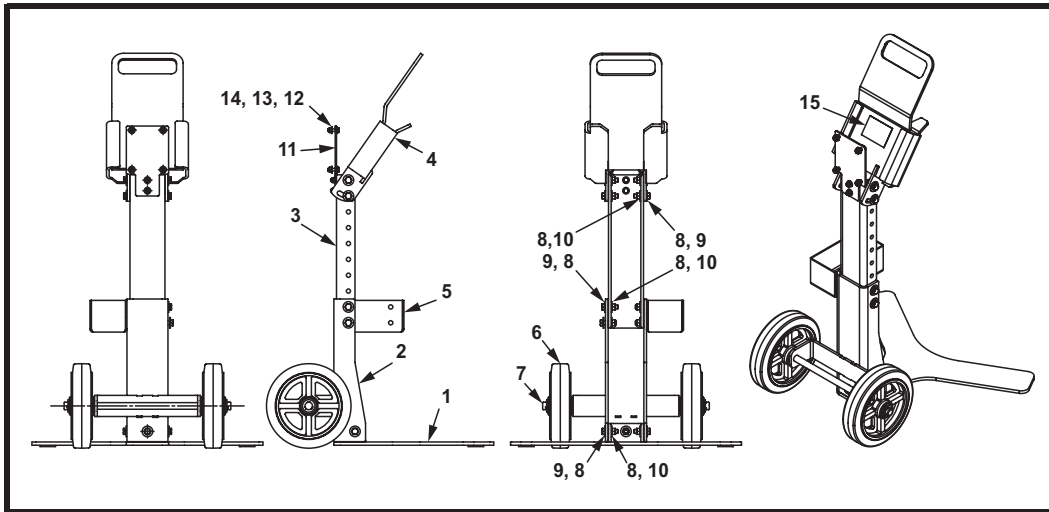

Figure 5. Railcar Vibrator Storage Stand & Cart Full Assembly



**Figure 6. Martin® Railcar Vibrator Storage Stand & Cart Parts List,  
P/N RV10016P**

Item	Description	Part No.	Qty.
1	Base Weldment - Orange	RV10005P	1
2	Lower Channel Weldment - Orange	RV10008P	1
3	Upper Channel - Orange	RV10009P	1
4	Wedge Weldment - Orange	RV10015P	1
5	Tool Tray - Orange	RV10010P	1
6	Caster Wheel ASM 8.00 X 2.00 X 5/8	SUS10231	2
7	Push-On Retaining Cap 5/8 ZP	SUS10232	2
8	Washer Flat 3/8 Wide ZP	18007	22
9	Screw HHC 3/8-16NC X 1-1/4 GR 5 ZP	12215	11
10	Nut Hex 3/8-16NC GR 5 ZP	11770	11
11	Regulator Mount Bracket - Orange	RV10011P	1
12	Washer Flat 1/4 Narrow ZP	39308	12
13	Screw HHC 1/4-20NC X 7/8 GR 5 ZP	11891	6
14	Nut Hex 1/4-20NC GR 5 ZP	11769	6
15	Label Martin Product	38048	1
(NS) 16	Manual Operator's	M4217	1

NS = Not Shown

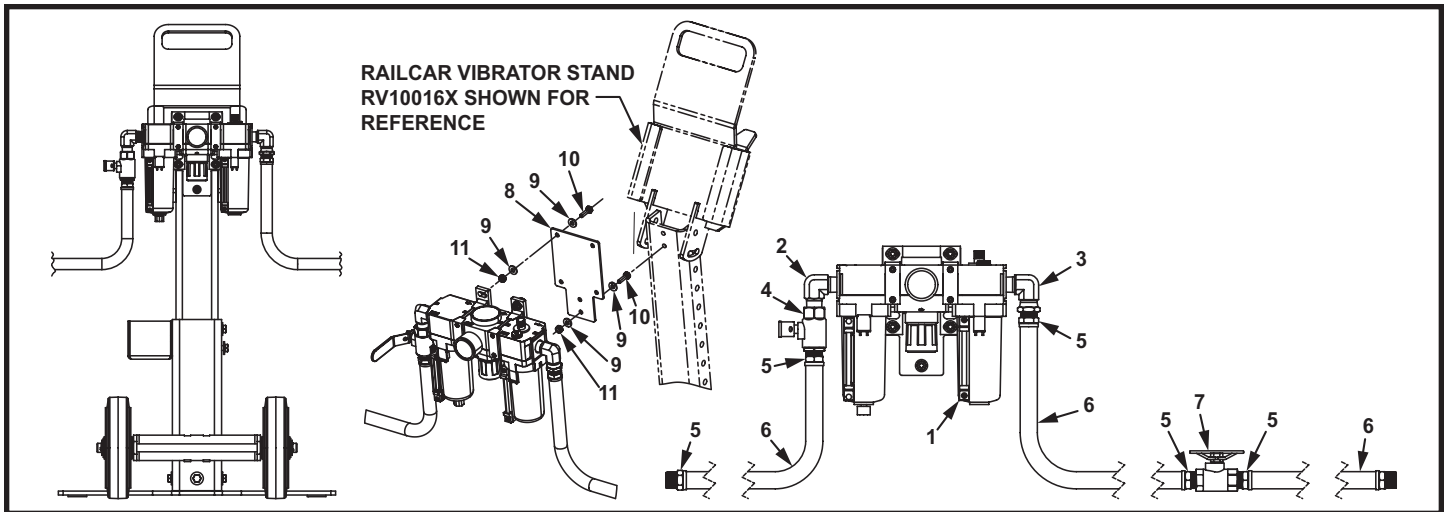

**Figure 7. Martin® Railcar Vibrator Storage Stand & Cart Assembly,  
P/N RV10016P with Optional Airline Control Kit, P/N 39504**

Item	Description	Part No.	Qty.
1	FRL 1/2-NPT	14760	1
2	Elbow Male 90 Deg 1/2-NPT X 1/2-NPT ZP	SUS10230	1
3	Elbow 1/2-NPT Male X 1/2 NPSM Femal Swivel	13368	1
4	Valve Ball Safety Shutoff 1/2-NPT	32284-01	1
5	Fitting Push-Lok® 1/2 Hose X 1/2-NPT Male	17235	6
6	Hose Gray 1/2 ID	17239	33 FT
7	Valve Ball 1/2-NPT Brass	14824-OH	1
8	Regulator Mount Bracket - Orange	RV10011P	1
9	Washer Flat 1/4 Narrow ZP	39308	12
10	Screw HHC 1/4-20NC GR 2 ZP	11891	6
11	Nut Hex 1/4-20NC GR 2 ZP	11769	6
(NS) 12	Fitting Push-Lok® 1/2 Hose X 3/4-NPT	17309	1
(NS) 13	Fitting Push-Lok® 1/2 Hose X 3/8-NPT	22463	1
(NS) 14	Fitting Push-Lok® 1/2 Hose X 1/4-NPT	39505	1
(NS) 15	Air Motor Oil Quart w/Spout	14766	1

NS = Not Shown