

## Martin® Pin Latch Secondary Belt Cleaner

### BENEFITS

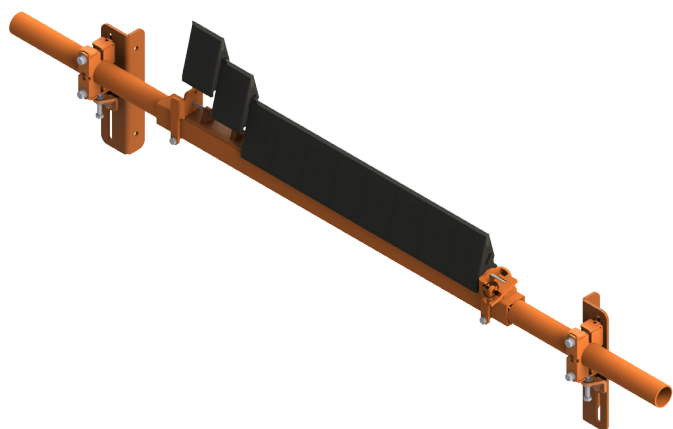

- Tungsten carbide-tipped segmented blades on a square mainframe smoothly rides over mechanical splices
- One-part blade and buffer requires no nuts and bolts
- Accommodates belt speeds of up to 6 m.s-1
- Accommodates belt rollback.
- Carbide tip is acid and abrasion resistant
- Simple service utilizes unique pin latch mechanism and integrated tool
- Simple installation does not require alignment or setting of the blades

### BRACKETS

| T BRACKET | "A"   |
|-----------|-------|
| 350mm     | 360mm |
| 450mm     | 460mm |

| CHANNEL T BRACKET | "B"   |
|-------------------|-------|
| 350mm             | 360mm |
| 450mm             | 460mm |
| 600mm             | 600mm |

| STD BRACKET | "C"   | "D"   |
|-------------|-------|-------|
| 250mm       | 150mm | 250mm |
| 350mm       | 250mm | 350mm |
| 450mm       | 350mm | 450mm |

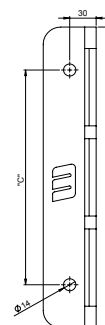
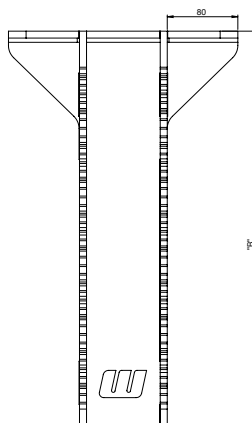
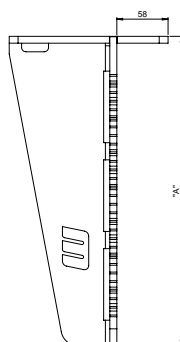
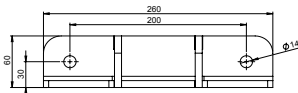
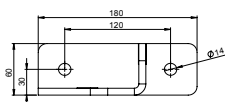

T BRACKET

CHANNEL T BRACKET

STANDARD BRACKET



**Martin Engineering RSA**  
 Cnr Antwerpen str & Arnheimsingel  
 Die Heuwel, Witbank, Emalahleni  
 Tel +27 13 656 5135  
 Fax +27 13 656 5129  
 www.martin-eng.co.za

Subject to change without prior notice.  
 Quality Management System Certified by DNV -  
 ISO 9001

