

Martin® BOCO Skirting

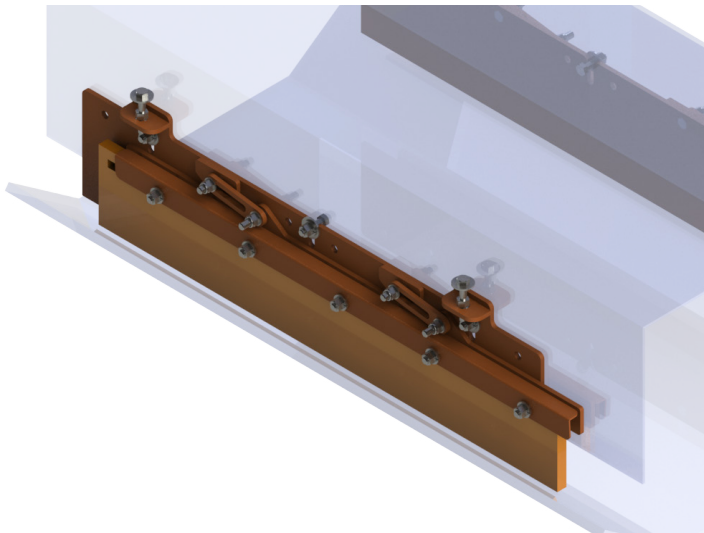

Martin® BOCO skirting provides an effective skirtboard seal that minimizes spillage and prevents the problems caused by fugitive material. It self-adjusts to eliminate skirtboard maintenance.

As it requires only 66 mm of free belt space outside the chute, Martin® Boco Skirting is the ideal sealing system for conveyors with chutes close to the belt edge. The polyurethane and clamp assembly can be installed in spaces as low as 300mm above the belt.

BENEFITS

- “Self-Adjusts” to Maintain Effective Barrier.
- Installs Easily in Tight Clearances.
- Prevents Regulatory Problems from Spillage.
- Minimizes Cleanup Labor and Expense.
- Preserves Conveyor Components from Fugitive Material.
- Keeps Cargo on Belt to Improve Conveyor Efficiency.

SPECIFICATIONS

Urethane Seal	
Material	Polyurethane
Thickness	20mm
Temperature Range	-29° to 121° C
Durometer	80 Shore A
Maximum Belt Speed	4.5 m/s

Clamp Assembly (Wear Strip and Pressure Plates)	
Material	Mild Steel
Length	1000mm
Installed Height	300mm

NOTES

- **Maintains Seal Without Maintenance**
System rides on belt, self-adjusting to maintain effective seal automatically as belt path fluctuates and sealing strip wears.
- **Lowest Belt Edge Requirement**
Fits on any belt; provides effective seal on conveyors where chute width leaves as little as 66 mm of free belt area for sealing.
- **Compact System Fits Tight Places**
Low-profile skirting assembly needs only 300 mm of clearance, allowing installation in small spaces.
- **Long-Lasting Performance**
Durable sealing strip provides 100 mm wear life. Zinc-plated moving parts will not seize or rust together.
- **Quick and Easy to Install**
Short 1000 mm clamp sections with built-in plug-weld guides simplify installation.
- **Guaranteed Installation Available from Martin Services**

TECHNICAL DATA SHEET

DIMENSIONS -- mm

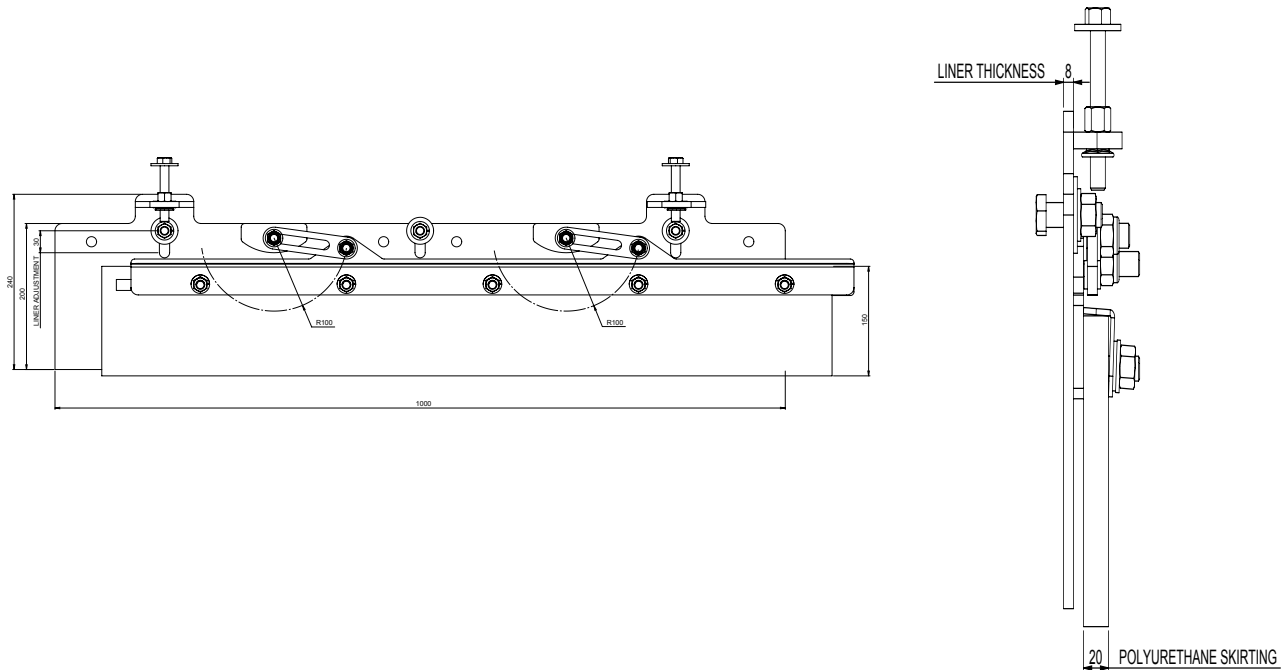

ORDER INFORMATION

Martin® Self Adjusting Skirting	Part Number	Length
Martin® BOCO Skirting	37911SA	1000mm
Polyurethane Blade Insert	BLADPOL100015020	1000mm

Order enough Clamp Assemblies to match installation requirements for both sides of conveyor.

Order polyurethane and field cut it into two strips to cover both sides of your conveyor.

NOTES

Martin BOCO skirting is suitable for installation on conveyors that reverse or roll back

Failure to keep the belt tracking properly may result in spillage, premature failure of the urethane skirting, and damage to the belt or structure.

Martin® BOCO Skirting XHD should begin at least 152 mm before the inlet side of the chute wall (closest to the tail pulley) and extend beyond the end of the chute.



Martin Engineering Africa
Cnr Antwerpen Str & Arnhemsingel
Die Heuwel, Witbank, 1035
Tel +27 13 656 5135
Fax +27 13 656 5129
www.martin-eng.co.za
feedback@martin-eng.com



Problem Solved™ GUARANTEED!

Form No. L4005-ZA Revised 08/16,07/23
© Martin Engineering Company 2016, 2023