

Martin® ApronSeal™ Double Skirting



Part Numbers

Heavy-Duty	100725
------------	--------

Accessories Order Info

Product	Part #
Heavy-Duty Angle Clamp Weldment <i>w/hardware inc. 5/8-11 studs, nuts, & washers</i>	34339A1000
Martin® ApronSeal™ Quick Release Clamps <i>fits standard & low-profile angle clamps</i>	36273

The [Martin® ApronSeal™ Double Skirting](#) is a primary and secondary sealing strip in a dual-sided single elastomer.

The self-adjusting secondary seal utilizes Martin Engineering's patented constant angle radial pressure technology to provide a more effective dust seal.

Benefits

- Provides effective sealing on higher speed belts.
- Offers dual life—dual sealing system in a one-piece construction.
- 70 Shore A EPDM durometer rubber composite offers good chemical resistance and low-abrasion index characteristics.
- Available in continuous lengths of 10 meters.
- Applicable on 0°, 20°, 35°, and 45° troughing angles.

ANGLE CLAMPS

Angle clamps are used to clamp the Martin® ApronSeal™ to chute wall, approximately 9 in. (229 mm) of head space is required for proper mounting.

Angle clamps are 1 meter long with mount studs on 12-inch (305-mm) centers. Center-pivot angle clamps are 3 ft (911 mm) long with clamp mounts on 18-inch (457-mm) centers.

Mounting height for studs and clamp mounts will vary with troughing angle and type of Martin® ApronSeal™ used. Consult Martin Engineering for mounting details.

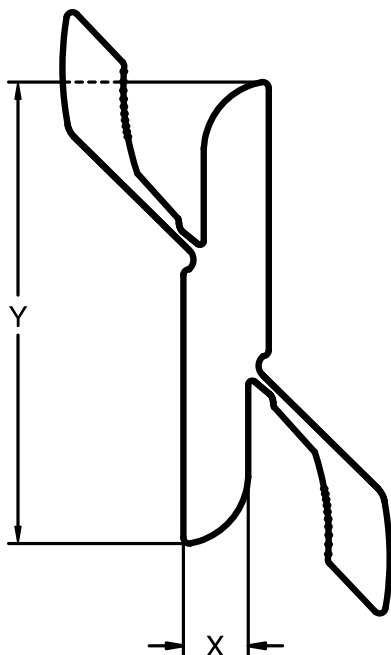

Dimensions— in. (mm)

Dimension	Heavy-Duty
X	0.68 (17)
Y	4.86 (123)

Minimum Free Belt Edge—in. (mm)

Trough Angle	Heavy-Duty
0°	2.97 (76)
20°	3.74 (95)
35°	4.18 (106)
45°	4.38 (111)



Martin Engineering Africa
Cnr Antwerpen St & Arnhemsingel
Die Heuwel, Witbank
Tel +27 13 656 5135
Fax +27 13 656 5129
www.martin-eng.co.za
feedback@martin-eng.com

