

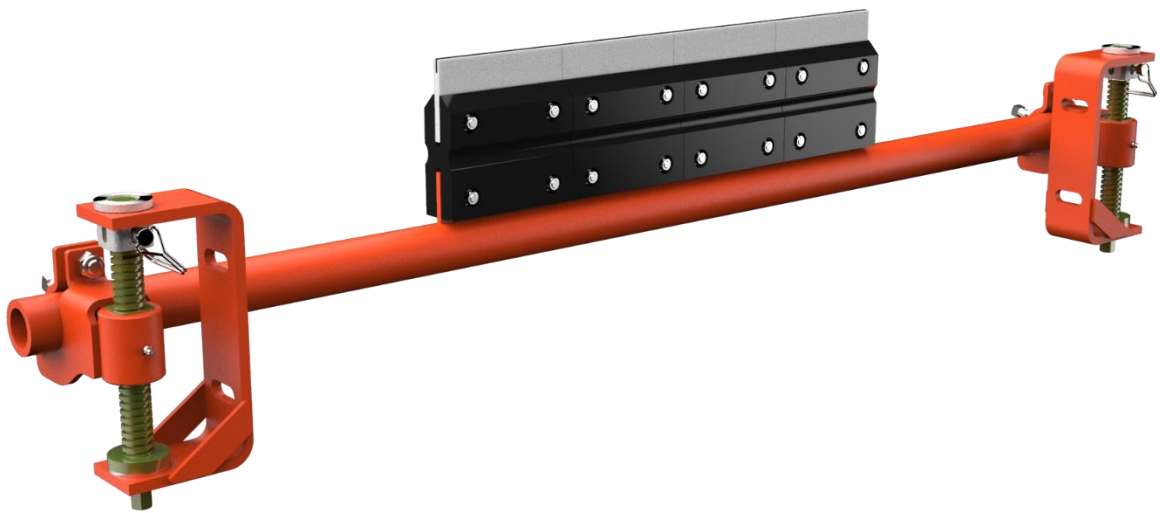

# SQC2™ Secondary Cleaner



## Operating Instructions Part 2

Version: 0  
Language: ENG  
M3682EUK-10/20

# Table of Contents

---

<b>1</b>	<b>General .....</b>	<b>2</b>
1.1	About these operating instructions .....	2
1.2	Accompanying Documents .....	2
1.3	Part number .....	3
1.4	Technical Data.....	3
<b>2</b>	<b>Installation .....</b>	<b>4</b>
2.1	Determining the installation position .....	4
2.2	Installing the tensioner.....	6
2.3	Installing the cleaner.....	7
2.4	Placing labels .....	9
<b>3</b>	<b>Scope of delivery and spare parts .....</b>	<b>10</b>

# 1 General

---



## NOTE

Before starting work on the cleaner or the conveyor, part 1 and 2 of these operating instructions must be read and understood completely

## 1.1 About these operating instructions

These operating instructions apply solely for cleaners and are intended for those persons who install cleaners, commission them, and monitor their usage.

The operating instructions must be kept for the lifetime of the cleaners and must be made available in an orderly condition to all persons entrusted with work with and on the cleaners.

## 1.2 Accompanying Documents

Part 1 of the operating instructions, which is provided separately, is an integral part of these operating instructions.

### 1.3 Part number

#### Cleaner

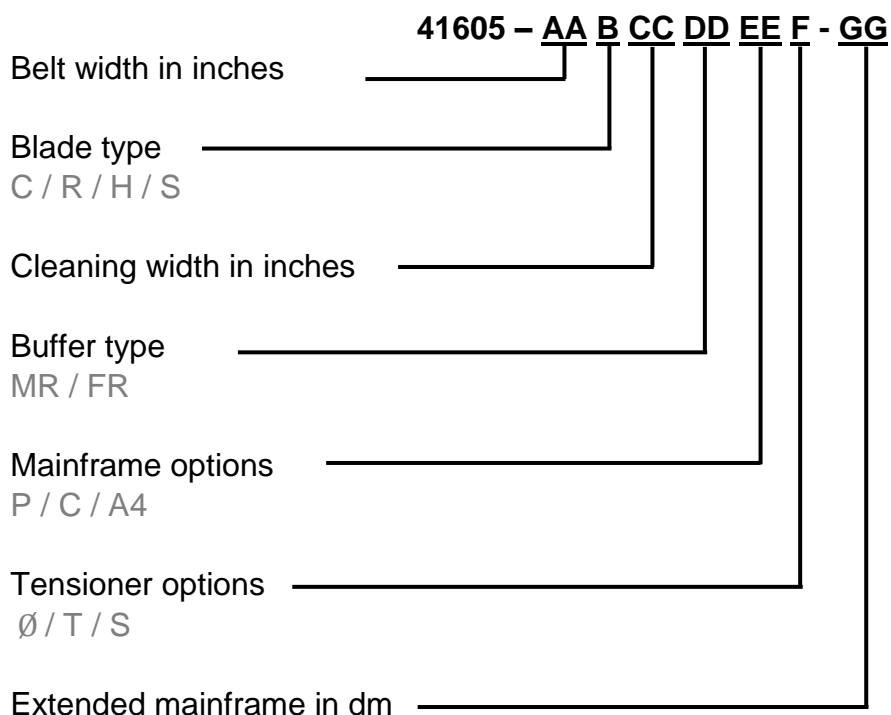

#### Tensioner

**SQC2-35701-xx**

### 1.4 Technical Data

The cleaner is suitable for the following operating parameters:

	Operating parameter
Belt widths:	450 – 3.000 mm
Belt speed:	Max. 5,1 m/s
Temperature range:	-30 - +75 °C (buffer type "MR"); -30 - +95 °C (buffer type "FR")
Reversing operation	Possible (all blade types except "H")

## 2 Installation



### NOTE

For a general description of cleaner installation, refer to part 1 of these operating instructions.

### 2.1 Determining the installation position

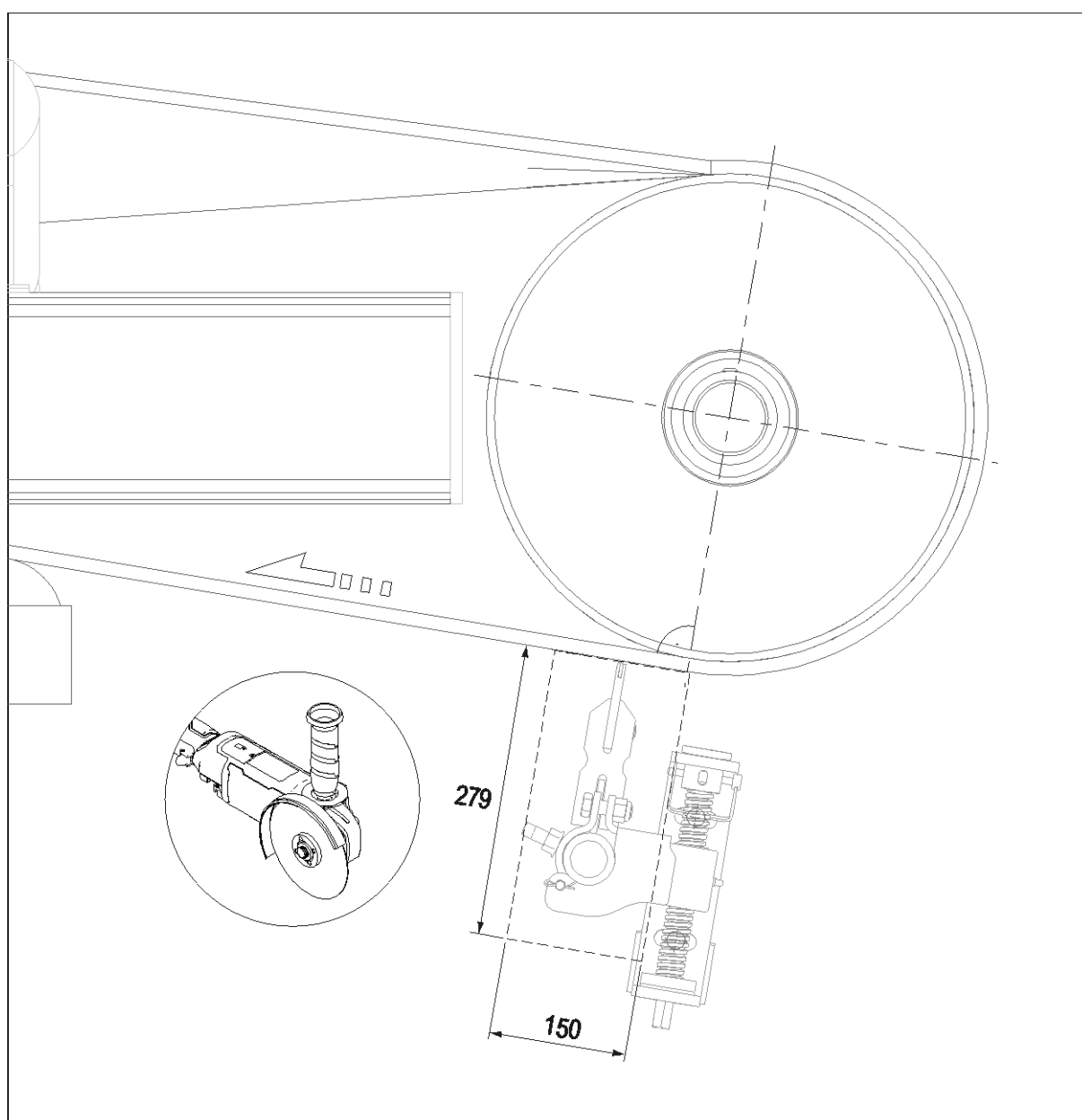

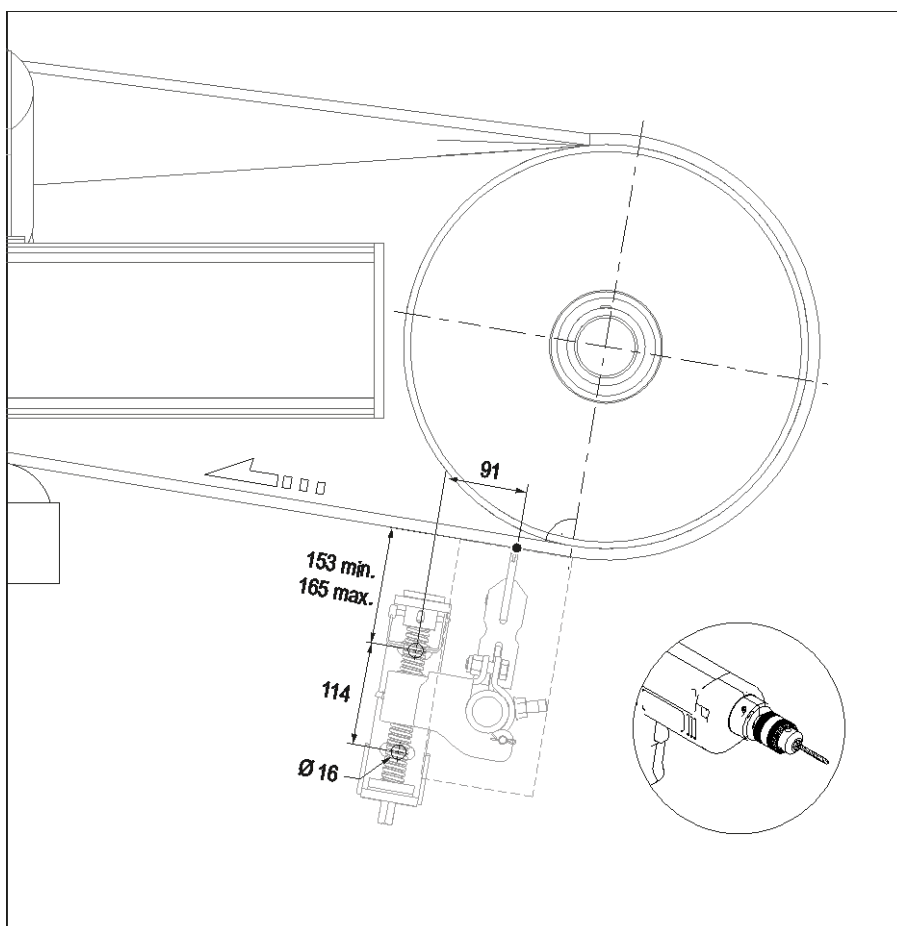
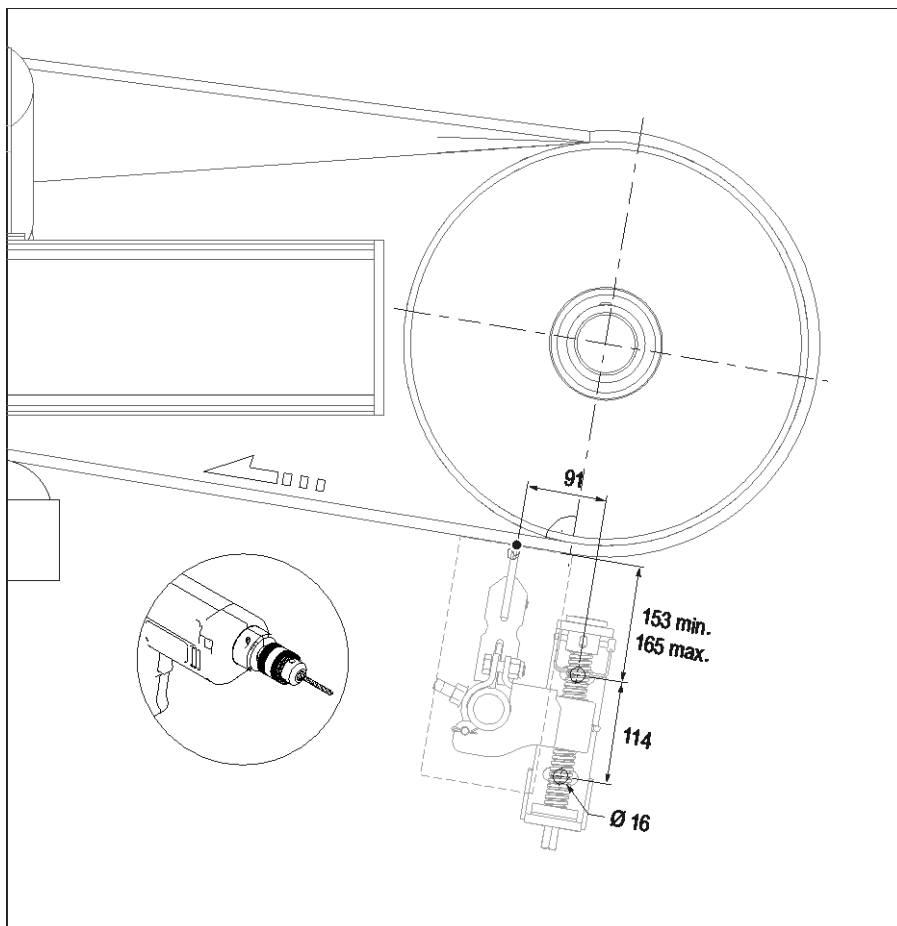

## 2.2 Installing the tensioner

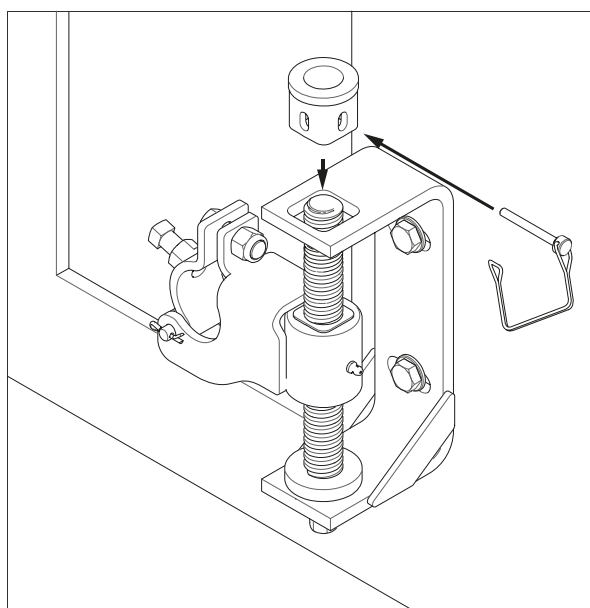
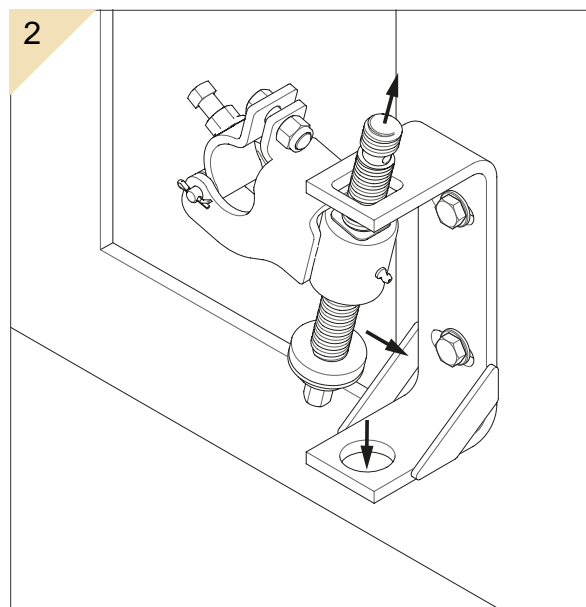
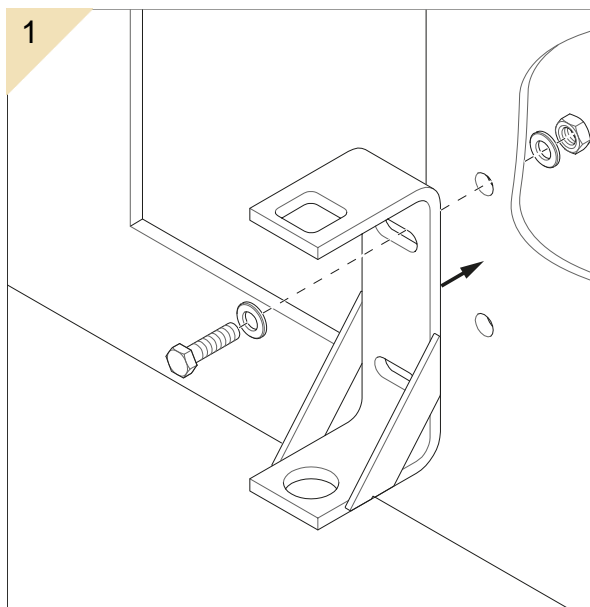

3

## 2.3 Installing the cleaner

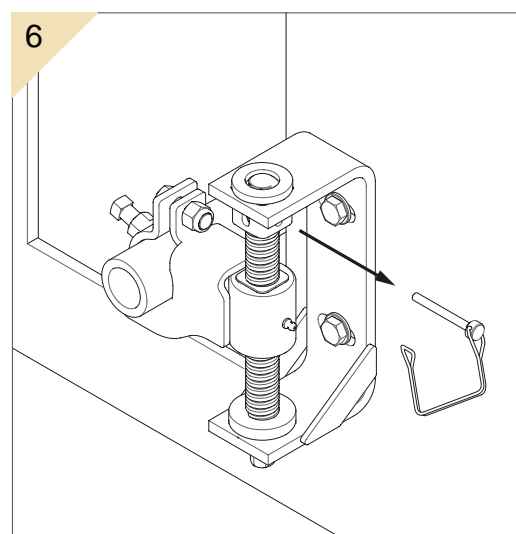
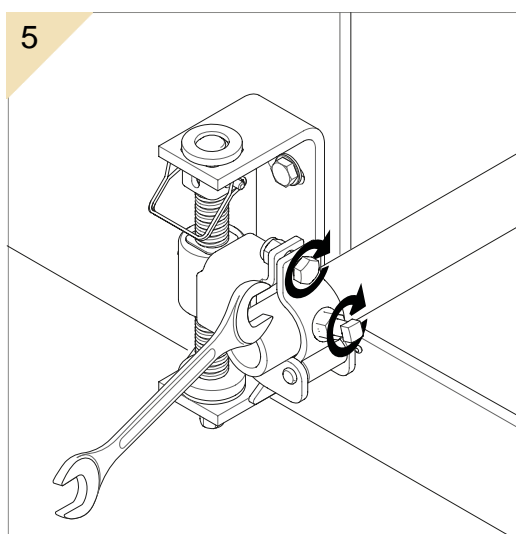
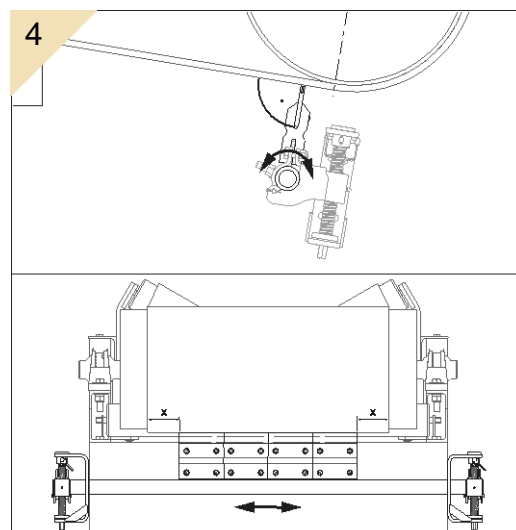
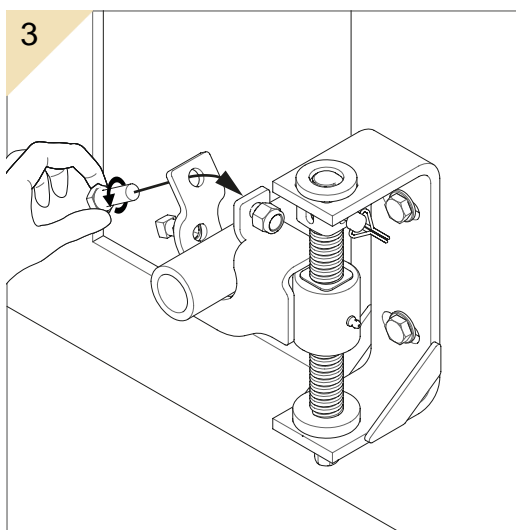
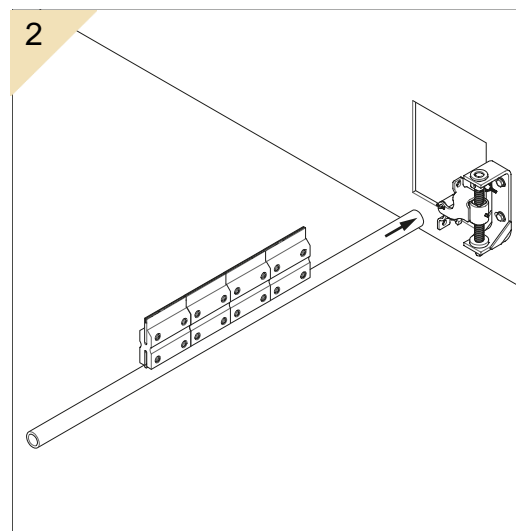
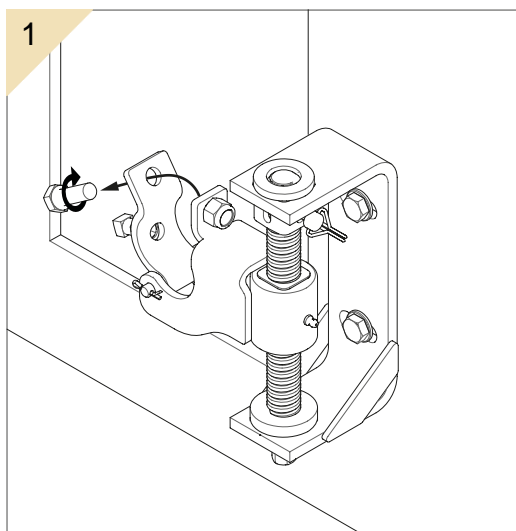



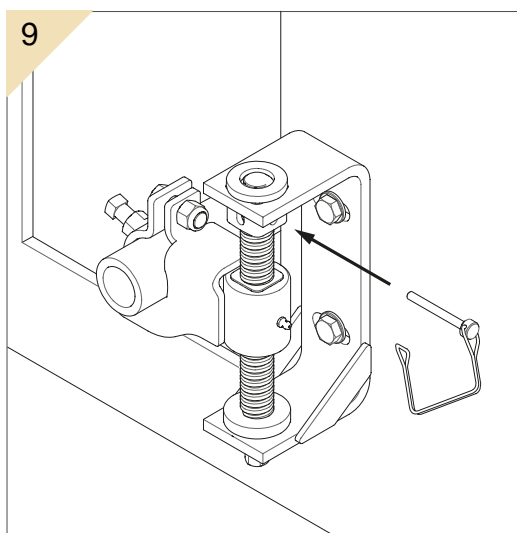
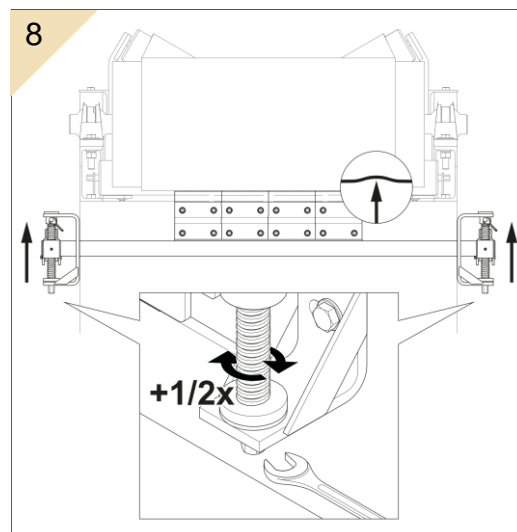
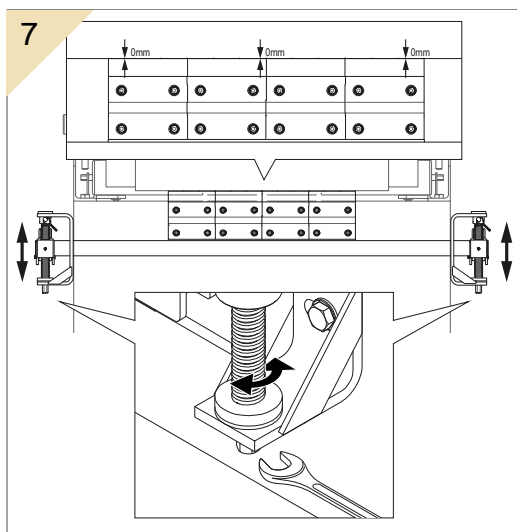

## 2.4 Placing labels

### 2.4.1 Safety label

The safety label below must be attached to the conveyor system in the immediate vicinity of the cleaner:



### 2.4.2 Other labels

The labels below are attached to the product:

1. Sticker showing the address of the Martin Engineering branch and the designation of the product
2. A sticker containing the tension values for the respective tensioner

### 3 Scope of delivery and spare parts

Part number / Teilenummer	DIM		P/N Item / Teilentr. Pos.	Qty. Item / Anzahl Pos.	P/N Item / Teilentr. Pos.	Qty. / Anz.	Part number / Teilenummer	P/N Item / Teilentr. Pos.	Qty. / Anz.	Description / Beschreibung	PIN / Teile-Nr.
	CW	ML									
41605-18X12XXXXX	300	1300	-	41667-18XX	2	4-7	41605-XXXXXXXSX	-	-	SQC2 mainframe / Hauptachse	41081-08035BA288
41605-18X18XXXXX	450	1300	-	41667-18XX	3	4	41605-XXXXXXXSX	-	-	SQC2 blade assembly / Blattbaugruppe	41086-08BA2
41605-24X18XXXXX	450	1450	-	41667-24XX	3	6	41605-XXXXXXXSX	-	-	SQC2 tensioner / Spannvorrichtung	41088-08AA2
41605-24X24XXXXX	600	1450	-	41667-24XX	4	8	41605-XXXXXXXSX	-	-	HHC screw M8 x 35 - DIN 933, (1.4301) / Sechskantschraube	41090-08AA2
41605-30X24XXXXX	600	1600	-	41667-30XX	4	8	41605-XXXXXXXSX	-	-	Hex nut M8 - DIN 934, (1.4301) / Sechskanmutter	41090-08AA2
41605-30X30XXXXX	750	1600	-	41667-30XX	5	10	41605-XXXXXXXSX	-	-	Washer flat M8 - DIN 125 A, (1.4301) / Unterlegscheibe	41090-08AA2
41605-36X30XXXXX	750	1750	-	41667-36XX	5	10	41605-XXXXXXXSX	-	-	Washer spring M8 - DIN 127, (1.4301) / Federring	41090-08AA2
41605-36X36XXXXX	900	1750	-	41667-36XX	6	12	41605-XXXXXXXSX	-	-		
41605-42X36XXXXX	900	1900	-	41667-42XX	6	12	41605-XXXXXXXSX	-	-		
41605-42X41XXXXX	1050	1900	-	41667-42XX	7	14	41605-XXXXXXXSX	-	-		
41605-48X41XXXXX	1050	2050	1250	41667-48XX	7	14	41605-XXXXXXXSX	-	-		
41605-48X47XXXXX	1200	2050	1250	41667-48XX	8	16	41605-XXXXXXXSX	-	-		
41605-54X47XXXXX	1200	2200	1400	41667-54XX	8	16	41605-XXXXXXXSX	-	-		
41605-54X53XXXXX	1350	2200	1400	41667-54XX	9	18	41605-XXXXXXXSX	-	-		
41605-60X53XXXXX	1350	2350	1550	41667-60XX	9	18	41605-XXXXXXXSX	-	-		
41605-60X59XXXXX	1500	2350	1550	41667-60XX	10	20	41605-XXXXXXXSX	-	-		
41605-66X59XXXXX	1500	2500	1700	41667-66XX	10	20	41605-XXXXXXXSX	-	-		
41605-66X65XXXXX	1650	2500	1700	41667-66XX	11	22	41605-XXXXXXXSX	-	-		
41605-72X65XXXXX	1650	2650	1850	41667-72XX	11	22	41605-XXXXXXXSX	-	-		
41605-72X71XXXXX	1800	2650	1850	41667-72XX	12	24	41605-XXXXXXXSX	-	-		
41605-78X71XXXXX	1800	2800	2000	41667-78XX	12	24	41605-XXXXXXXSX	-	-		
41605-78X77XXXXX	1950	2800	2000	41667-78XX	13	26	41605-XXXXXXXSX	-	-		
41605-84X77XXXXX	1950	2950	2150	41667-84XX	13	26	41605-XXXXXXXSX	-	-		
41605-84X83XXXXX	2100	2950	2150	41667-84XX	14	28	41605-XXXXXXXSX	-	-		
41605-90X83XXXXX	2100	3100	2300	41667-90XX	14	28	41605-XXXXXXXSX	-	-		
41605-90X89XXXXX	2250	3100	2300	41667-90XX	15	30	41605-XXXXXXXSX	-	-		
41605-96X89XXXXX	2250	3250	2450	41667-96XX	15	30	41605-XXXXXXXSX	-	-		
41605-102X96XXXXX	2400	3400	2600	41667-102XX	16	32	41605-XXXXXXXSX	-	-		
41605-108X100XXXXX	2550	3550	2750	41667-108XX	17	34	41605-XXXXXXXSX	-	-		
41605-114X106XXXXX	2700	3700	2900	41667-114XX	18	36	41605-XXXXXXXSX	-	-		
41605-120X112XXXXX	2850	3850	3050	41667-120XX	19	38	41605-XXXXXXXSX	-	-		

Part number / Teilenummer	P/N Item / Teilentr. Pos.	Type Typ
41605-XXXXXXXSX	2	SC-XXC+E A
41605-XXXXXXXSX	3	SC-XXR+E A
41605-XXXXXXXSX	4	SC-XXH+E B
41605-XXXXXXXSX	5	SC-XXS+E C

Shown / Dargestellt  
41605-24X18XXXX

Belt cleaner without reinforcement  
Abstreifer ohne verstärkte Hauptachse

Rev. No.	Description	Date	By
M	Change blade -to mild steel	27.10.20	sm
L	Removed TM from description	27.06.17	sm
K	Removed column BW, changed layout	16.03.16	sm

Rev. No.	Description	Date	By
1	SQC2 Secondary cleaner SOC2 Hauptabstreifer	27/10/2020	sm
2			
3			
4			
5			
6			
7			
8			
9			
10			
11			
12			
13			
14			
15			
16			
17			
18			
19			
20			
21			
22			
23			
24			
25			
26			
27			
28			
29			
30			
31			
32			
33			
34			
35			
36			
37			
38			
39			
40			
41			
42			
43			
44			
45			
46			
47			
48			
49			
50			
51			
52			
53			
54			
55			
56			
57			
58			
59			
60			
61			
62			
63			
64			
65			
66			
67			
68			
69			
70			
71			
72			
73			
74			
75			
76			
77			
78			
79			
80			
81			
82			
83			
84			
85			
86			
87			
88			
89			
90			
91			
92			
93			
94			
95			
96			
97			
98			
99			
100			

Note / Bemerkung:  
\* For extended mainframe see drawing  
Für verlängerte Hauptachse siehe Zeichnung 41605-XXXXXXXSX-XX

Part number / Teilenummer	Parameter
41605-subcode/ef-ig	For extended mainframe in Zoll
a	Blade type
b	Blade width in inch
c	Blade length in inch
d	Blade thickness in inch
e	Blade material
f	Blade finish
g	Blade coating
h	Blade color
i	Blade weight
j	Blade volume
k	Blade surface area
l	Blade perimeter
m	Blade area
n	Blade volume
o	Blade weight
p	Blade volume
q	Blade weight
r	Blade volume
s	Blade weight
t	Blade volume
u	Blade weight
v	Blade volume
w	Blade weight
x	Blade volume
y	Blade weight
z	Blade volume



### **Germany**

Martin Engineering GmbH  
In der Rehbach 14, 65396 Walluf, Germany  
Tel. +49 (0)6123 97820; Fax +49 (0)6123 75533  
info@martin-eng.de; www.martin-eng.de

### **Spain**

Martin Engineering Spain  
c/Balmes 297 1er 2a, 08006 Barcelona, Spain  
Tel. +34 (0)876 245114; Fax +34 (0)966 719371  
info@martin-eng.es; www.martin-eng.es

### **Great Britain**

Martin Engineering Ltd.  
8, Experian Way, NG2 Business Park,  
Nottingham NG2 1EP, Nottinghamshire, Great Britain  
Tel +44 115 946 4746; Fax +44 115 946 5550  
info@martin-eng.co.uk; www.martin-eng.co.uk

### **Turkey**

Martin Engineering Türkiye  
Yukarı Dudullu İmes Sanayi Sitesi, B Blok 205 Sokak No.6  
34775 Ümraniye İstanbul, Turkey  
Tel +90 216 499 34 91; Fax +90 216 499 34 90  
info@martin-eng.com.tr; www.martin-eng.com.tr

### **France**

Martin Engineering SARL  
50 Avenue d'Alsace, 68025 Colmar Cedex, France  
Tel +33 389 20 63204; Fax +33 389 20 4379  
info@martin-eng.fr; www.martin-eng.fr

### **Italy**

Martin Engineering Italy Srl  
Via Buonarroti, 43/A, 20064 Gorgonzola (MI), Italy  
Tel +39 295 3838 51; Fax +39 295 3838 15  
info@martin-eng.it; www.martin-eng.it

### **Russia**

OOO Martin Engineering  
Ul. Bolshaya Dmitrovka, 23/1  
125009 Moscow, Russia  
Tel +7 495 181 33 43; Fax +7 499 720 62 12  
info@martin-eng.ru; www.martin-eng.ru