



MARTIN® DT2H XHD Secondary Cleaner

The MARTIN® DT2H XHD Secondary Belt Cleaner features rugged blades installed on a track that slides into cleaning position on a rugged steel mandrel. This unique design makes for a quick and easy service procedure that reduces conveyor downtime and improves productivity.



MARTIN® DT2H
XHD IN-LINE Blade



Benefits

- Removes Carryback, Saves Cleanup**
 Effective belt cleaning reduces plant cleanup chores and prolongs life of conveyor components.
- Reduces Downtime for Service**
 Slide-in/slide-out mandrel allows quick and easy blade replacement to increase conveyor availability.
- Slide-Out/Slide-In Blade Change**
 Individual blade segments slide into sturdy track-forming cartridge. This cartridge slides over stainless steel mainframe into cleaning position.
- Split Track Cartridge**
 Split track cartridge design allows simple blade removal even with material accumulation.
- Built Strong for Tough Conditions**
 Massive MARTIN® XHD Blades stand up to challenging conditions, including heavy material loads and belt speeds up to 6 m/sec.

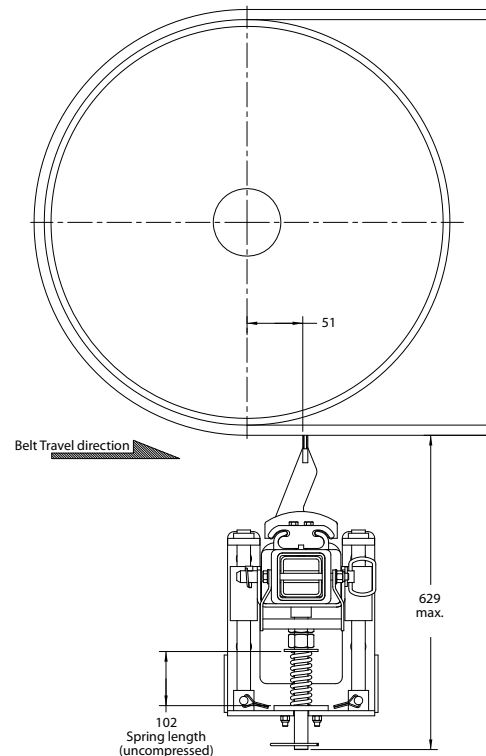

Nomenclature

| BLADE TYPE | URETHANE COLOUR | MAINFRAME TYPE | TENSIONER |
|--------------------------------------|-----------------|----------------|----------------------|
| O = No Blades | BR = Brown | P = Standard | A = Air Tensioner |
| T = Tungsten Carbide Reversing Blade | GR = Green | | S = Spring Tensioner |
| A = IN-LINE Tungsten Carbide Blade | OR = Orange | | |
| U = Urethane Reversing Blade | | | |

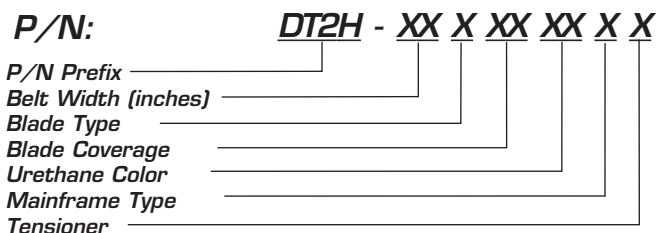

Dimensions

| Belt Width in (mm) | No. of Blades | Blade Coverage mm | Max. Mainframe Length mm | Weight w/o Tensioner kg | Assembly P/N with tensioner |
|--------------------|---------------|-------------------|--------------------------|-------------------------|-----------------------------|
| 18 (300-500) | 2 | 305 | 1257 | 84 | DT2H-18XXXXXXXXXX |
| | 3 | 457 | | 91 | |
| 24 (500-650) | 3 | 457 | 1410 | 101 | DT2H-24XXXXXXXXXX |
| | 4 | 610 | | 108 | |
| 30 (650-800) | 4 | 610 | 1562 | 118 | DT2H-30XXXXXXXXXX |
| | 5 | 762 | | 125 | |
| 36 (800-1000) | 5 | 762 | 1715 | 135 | DT2H-36XXXXXXXXXX |
| | 6 | 914 | | 142 | |
| 42 (1000-1200) | 6 | 914 | 1867 | 153 | DT2H-42XXXXXXXXXX |
| | 7 | 1067 | | 160 | |
| 48 (1200-1400) | 7 | 1067 | 2019 | 170 | DT2H-46XXXXXXXXXX |
| | 8 | 1219 | | 177 | |
| 54 (1400-1600) | 8 | 1219 | 2172 | 187 | DT2H-54XXXXXXXXXX |
| | 9 | 1372 | | 194 | |
| 60 (1600-1800) | 9 | 1372 | 2324 | 204 | DT2H-60XXXXXXXXXX |
| | 10 | 1524 | | 211 | |
| 72 (1800-2000) | 11 | 1676 | 2629 | 238 | DT2H-72XXXXXXXXXX |
| 84 (2000-2200) | 13 | 1981 | 2934 | 272 | DT2H-84XXXXXXXXXX |
| 96 (2200-2400) | 15 | 2286 | 3239 | 307 | DT2H-96XXXXXXXXXX |

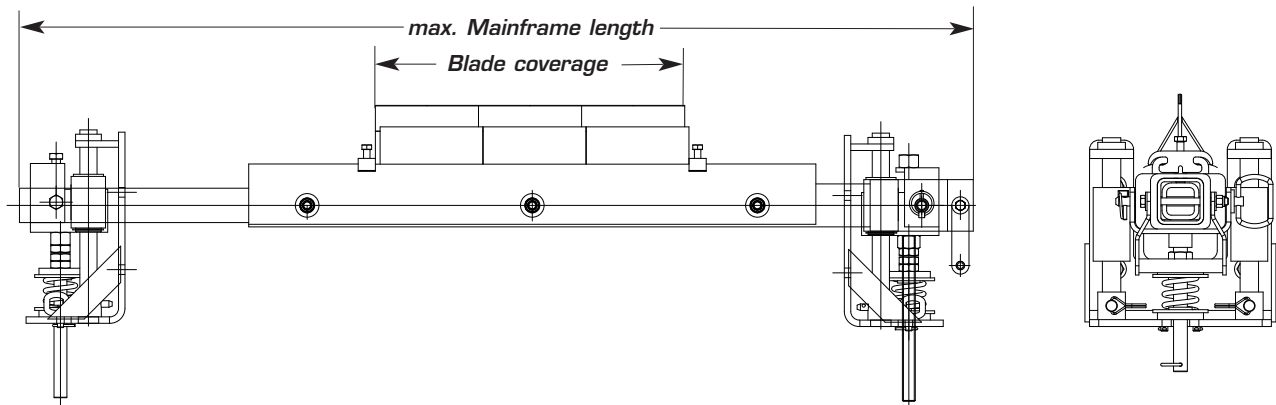

MARTIN® DT2H REPLACEMENT BLADES

| | |
|-------------------------------|------------|
| MARTIN® IN-LINE™ Blade | P/N |
| Tungsten Carbide | 36936-T |

| | |
|--------------------------------------|------------|
| DURT TRACKER® Reversing Blade | P/N |
| Tungsten Carbide | 32494-TXX |
| Urethane | 32494-06U |



MARTIN ENGINEERING GMBH
 Headquarter Europe
 In der Rehbach 14
 D-65396 Walluf, Germany
 Ph.: 0049 (0)6123 97820
 Fax: 0049 (0)6123 75533
 E-Mail: info@martin-eng.de
www.martin-eng.de



MARTIN® IN-LINE Belt Cleaner is protected by U.S. Patent No. 6,581,754.
 Changes of construction and given data are reserved