

Martin® Skirtboard Liner



Installed inside conveyor transfer point skirtboards, **Martin® Skirtboard Liner** absorb impact and abrasion and creates a dam to shield the sealing system from the weight of the material load, prolonging the life of the seal.

The Martin Skirtboard Liner feature a steel plate molded inside the urethane to prevent bond issues. Liners are also stackable to line higher drop chutes.

NOMENCLATURE

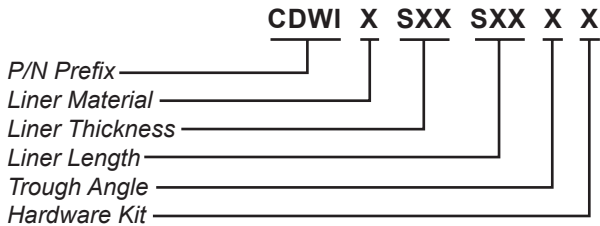

LINER MATERIAL
U: Urethane

LINER THICKNESS
13: 1.3 inches
20: 2.0 inches

LINER LENGTH
48: 48 inches

TROUGH ANGLE
2: 20 degree
3: 35 degree
4: 45 degree

HARDWARE KIT
0: Without Hardware
K: With Hardware

DIMENSIONS — IN. (MM)

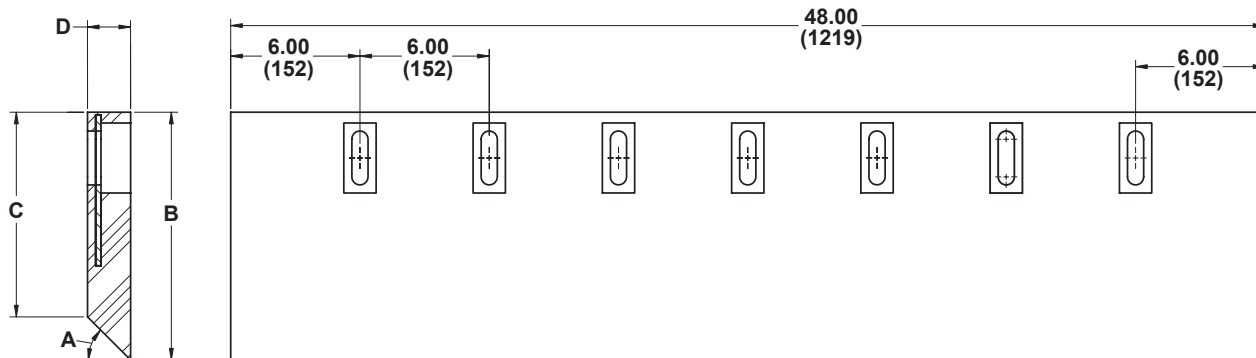

Dim. A Trough Angle	Dim. B in. (mm)		Dim. C in. (mm)		Dim. D in. (mm)	
	CDWIUS13S48X0	CDWIUS20S48X0	CDWIUS13S48X0	CDWIUS20S48X0	CDWIUS13S48X0	CDWIUS20S48X0
20 Degrees	6.75 (172)	9.88 (251)	6.30 (160)	9.15 (233)	1.25 (32)	2.00 (51)
35 Degrees		10.75 (273)	5.87 (149)	9.35 (238)		
45 Degrees		11.50 (292)	5.50 (140)	9.50 (241)		



Martin Engineering Australia Pty Ltd.
 20 Ern Harley Dr - Burleigh Heads, QLD, 4220 - Australia
 1300 627 364
www.martin-eng.com.au

