

# Martin® Manufactured Canoe Liners



Installed inside conveyor transfer point skirtboards, [Martin® Manufactured Canoe Liners](#) absorb impact and abrasion and creates a dam to shield the sealing system from the weight of the material load, prolonging the life of the seal.

The Martin Manufactured Canoe Liners feature a steel plate molded inside the urethane to prevent bond issues. Liners are also stackable to line higher drop chutes.

## NOMENCLATURE

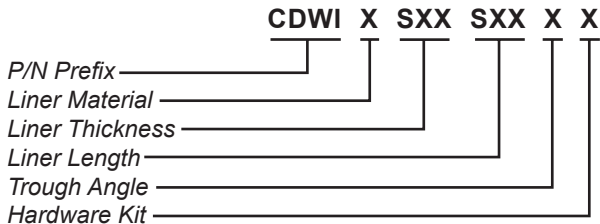

**LINER MATERIAL**  
**U:** Urethane

**LINER THICKNESS**  
**13:** 1.3 inches  
**20:** 2.0 inches

**LINER LENGTH**  
**48:** 48 inches

**TROUGH ANGLE**  
**2:** 20 degree  
**3:** 35 degree  
**4:** 45 degree

**HARDWARE KIT**  
**0:** Without Hardware  
**K:** With Hardware

## DIMENSIONS — IN. (MM)

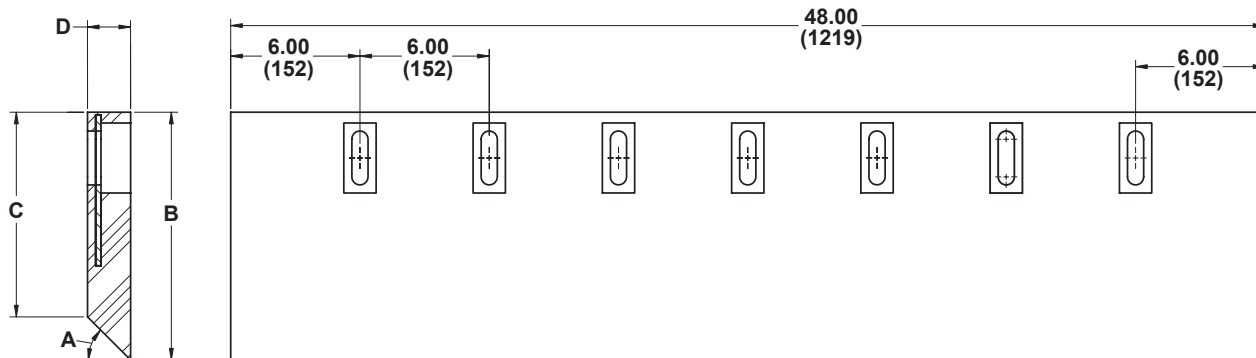

Dim. A Trough Angle	Dim. B in. (mm)		Dim. C in. (mm)		Dim. D in. (mm)	
	CDWIUS13S48X0	CDWIUS20S48X0	CDWIUS13S48X0	CDWIUS20S48X0	CDWIUS13S48X0	CDWIUS20S48X0
20 Degrees	6.75 (172)	9.88 (251)	6.30 (160)	9.15 (233)	1.25 (32)	2.00 (51)
35 Degrees		10.75 (273)	5.87 (149)	9.35 (238)		
45 Degrees		11.50 (292)	5.50 (140)	9.50 (241)		



**Martin Engineering Australia Pty Ltd.**  
 20 Ern Harley Dr - Burleigh Heads, QLD, 4220 - Australia  
 1300 627 364  
[www.martin-eng.com.au](http://www.martin-eng.com.au)

